

G:\KinderMorgans\939501_NED\ProjectData\Prod\Work\GIS\MXD\NED_EAST_QUAD_MAPBOOK.mxd

09/11/2014-1117-AMS-000

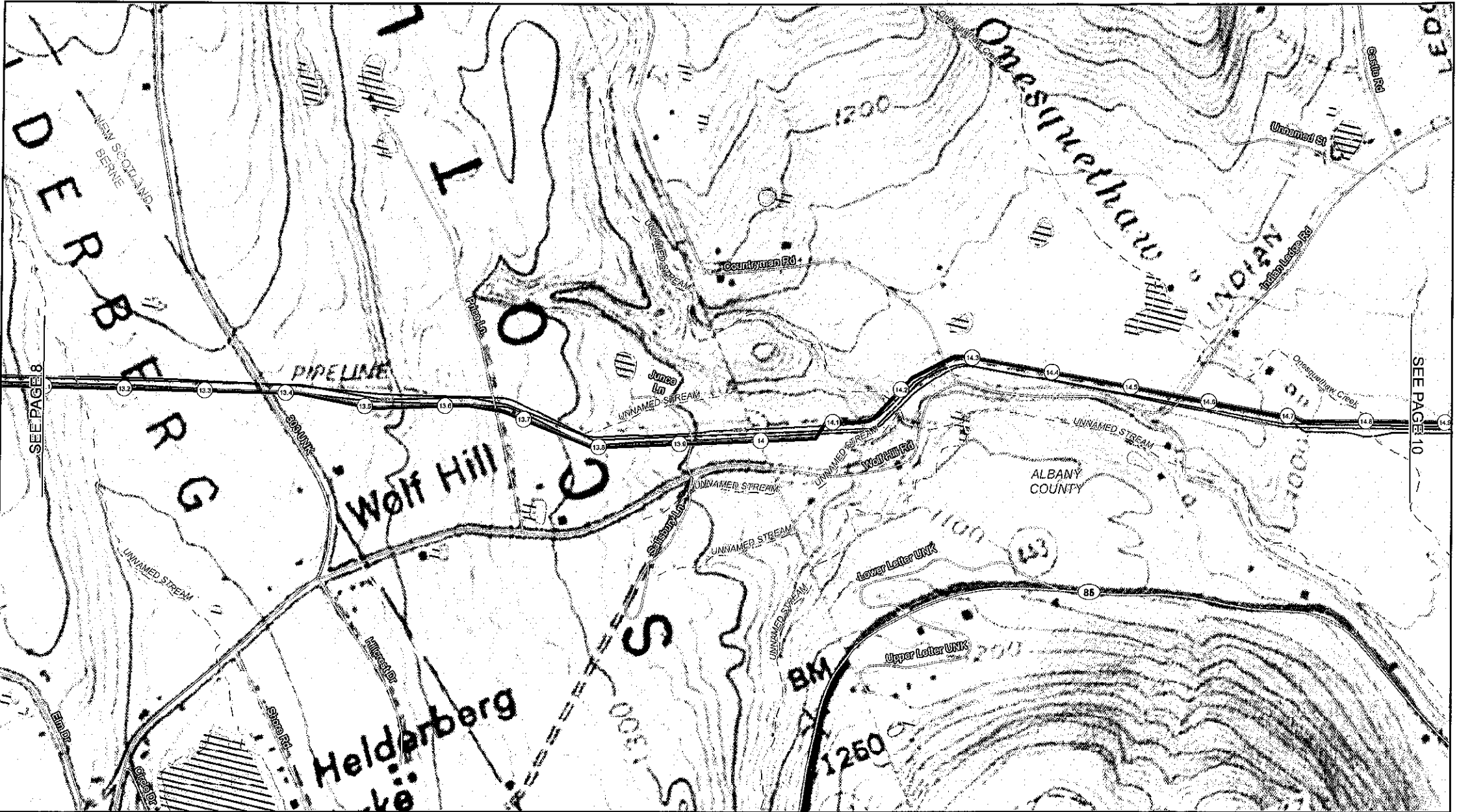

Legend	
① MILE POST	CONSTITUTION PIPELINE CENTERLINE
⊙ METER LOCATIONS	SWM PIPELINE
⊙ WELLS	EXISTING TGP PIPELINE
— PROPOSED NORTHEAST ENERGY DIRECT MARKET PATH CENTERLINE	INTERSTATE
— PROPOSED NORTHEAST ENERGY DIRECT LATERAL CENTERLINE	MAJOR HIGHWAY
	LOCAL ROAD
	RAILROAD
	NHD STREAM / RIVER
	POTENTIAL COMPRESSOR STATION LOCATION
	NW WETLAND
	NHD WATERBODY
	MUNICIPAL BOUNDARY
	COUNTY BOUNDARY
	STATE BOUNDARY

TENNESSEE GAS PIPELINE COMPANY, L.L.C.
NORTHEAST ENERGY DIRECT PROJECT
 (MARKET PATH COMPONENT)
 ALBANY COUNTY
 NEW YORK

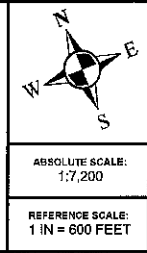

Tennessee Gas Pipeline Company, L.L.C.
 a Kinder Morgan company

Hatch Mott MacDonald

150 Lower Westfield Rd.
 Holyoke, MA 01040
 Ph: (413) 535-0135 Fax: (413) 535-0136

PRELIMINARY FOR REVIEW 9/11/2014
 TENNESSEE GAS PIPELINE, LLC PROPRIETARY

DRAWN BY:	HMM 9/11/2014
CHECKED BY:	HMM
APPROVED BY:	HMM
REV. DATE:	9/11/2014
REVISION:	1
DESC:	SUBMIT FOR REVIEW
PAGE:	9 OF 99



MAPS COMPILED UTILIZING EXISTING PUBLICLY AVAILABLE GIS RESOURCES.

SEE PAGE 8

SEE PAGE 10

G:\KinderMorgan\339501_NED\ProjectID\data\Prod\Work\GIS\MXD\MED_EAST_QUAD_MAPBOOK.mxd
09/11/2014-1117-AMS-000



Legend

- | | | |
|---|------------------------------------|---|
| ① MILE POST | — CONSTITUTION PIPELINE CENTERLINE | ○ POTENTIAL COMPRESSOR STATION LOCATION |
| ○ METER LOCATIONS | — SW PIPELINE | ▨ NW WETLAND |
| ○ WELLS | — EXISTING TOP PIPELINE | ▨ NHD WATERBODY |
| — PROPOSED NORTHEAST ENERGY DIRECT MARKET PATH CENTERLINE | — INTERSTATE | ▨ MUNICIPAL BOUNDARY |
| — PROPOSED NORTHEAST ENERGY DIRECT LATERAL CENTERLINE | — MAJOR HIGHWAY | ▨ COUNTY BOUNDARY |
| | — LOCAL ROAD | ▨ STATE BOUNDARY |
| | — RAILROAD | |
| | — NHD STREAM / RIVER | |

MAPS COMPILED UTILIZING EXISTING PUBLICLY AVAILABLE GIS RESOURCES.

**TENNESSEE GAS PIPELINE COMPANY, L.L.C.
NORTHEAST ENERGY DIRECT PROJECT**

(MARKET PATH COMPONENT)

ALBANY COUNTY
NEW YORK

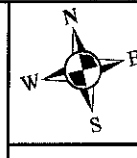

ABSOLUTE SCALE:
1:7,200

REFERENCE SCALE:
1 IN = 600 FEET

Tennessee Gas Pipeline Company, L.L.C.
a Kinder Morgan Company

Hatch Mott MacDonald
150 Lower Westfield Rd.
Hoboken, MA 01040
Ph: (413) 535-0135 Fax: (413) 535-0136

PRELIMINARY FOR REVIEW 9/11/2014
TENNESSEE GAS PIPELINE, LLC PROPRIETARY

DRAWN BY: HMM 9/11/2014

CHECKED BY: HMM

APPROVED BY: HMM

REV. DATE: 9/11/2014

REVISION: 1

DESC: SUBMIT FOR REVIEW

PAGE: 10 OF 99

G:\KinderMorgan\839501_NED\ProjectData\Prod\Work\GIS\IMX\DW\NED_EAST_QUAD_MAPBOOK.mxd
09/11/2014-1117-AMS-000

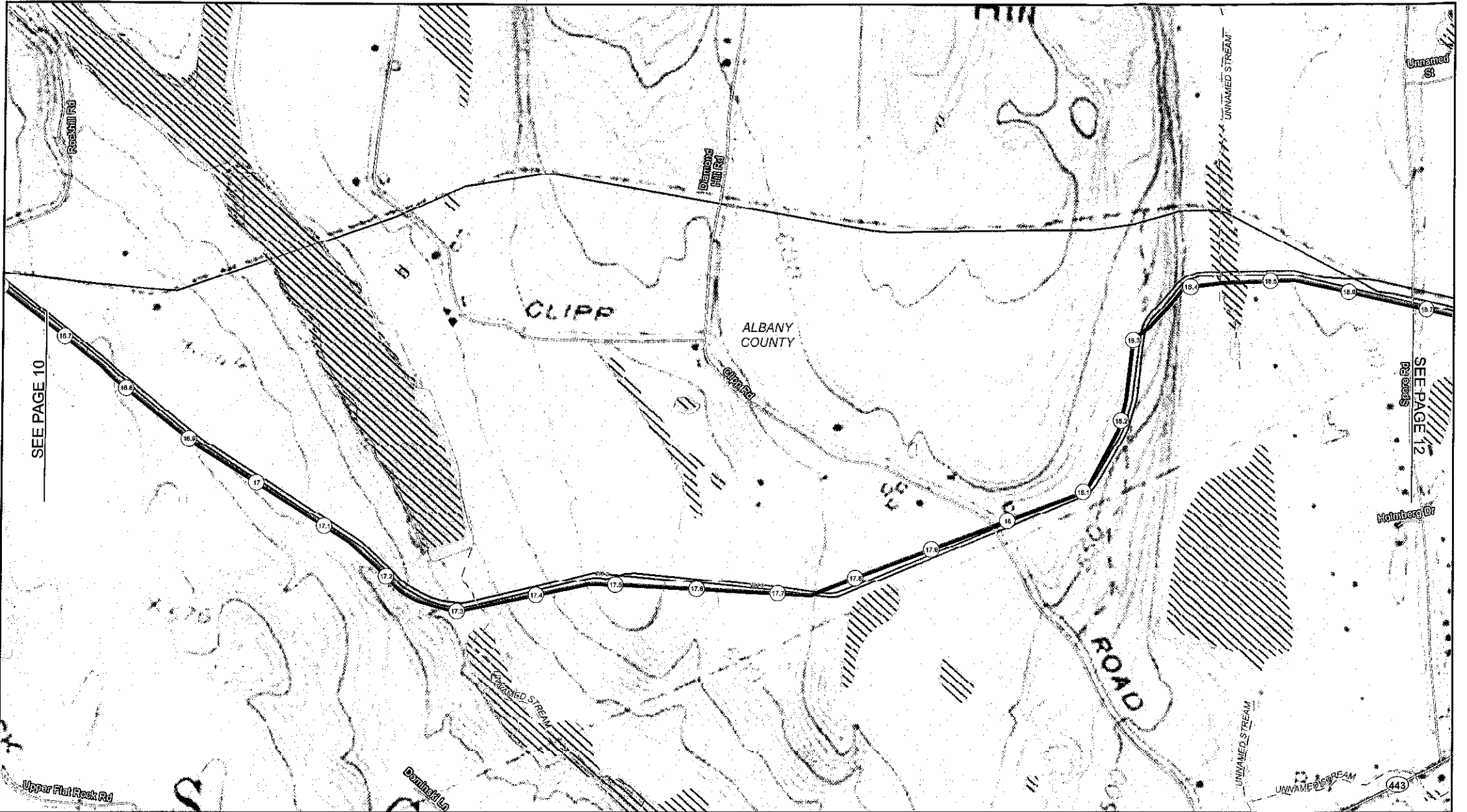

Legend	
① MILE POST	CONSTITUTION PIPELINE CENTERLINE
⊙ METER LOCATIONS	SWP PIPELINE
⊙ WELLS	EXISTING TOP PIPELINE
— PROPOSED NORTHEAST ENERGY DIRECT MARKET PATH CENTERLINE	INTERSTATE
— PROPOSED NORTHEAST ENERGY DIRECT LATERAL CENTERLINE	MAJOR HIGHWAY
	LOCAL ROAD
	RAILROAD
	NHD STREAM / RIVER
	POTENTIAL COMPRESSOR STATION LOCATION
	NHD WETLAND
	NHD WATERBODY
	MUNICIPAL BOUNDARY
	COUNTY BOUNDARY
	STATE BOUNDARY

MAPS COMPILED UTILIZING EXISTING PUBLICLY AVAILABLE GIS RESOURCES.

TENNESSEE GAS PIPELINE COMPANY, L.L.C.
NORTHEAST ENERGY DIRECT PROJECT
 (MARKET PATH COMPONENT)
 ALBANY COUNTY
 NEW YORK

600 300 0 600 1,200 FEET

N
W E
S

ABSOLUTE SCALE:
1:7,200

REFERENCE SCALE:
1 IN = 800 FEET

Tennessee Gas Pipeline Company, L.L.C.
 a Kinder Morgan company

Hatch Mott MacDonald

PRELIMINARY FOR REVIEW 9/11/2014
 TENNESSEE GAS PIPELINE, LLC PROPRIETARY

DRAWN BY:	HMM 9/11/2014
CHECKED BY:	HMM
APPROVED BY:	HMM
REV. DATE:	9/11/2014
REVISION:	1
DESC:	SUBMIT FOR REVIEW
PAGE:	11 OF 99

G:\KinderMorgan\339501_NED\ProjectData\Prod\Work\GIS\X\NED_EAST_QUAD_MAPBOOK.mxd
 09112014-1117-AMS-000

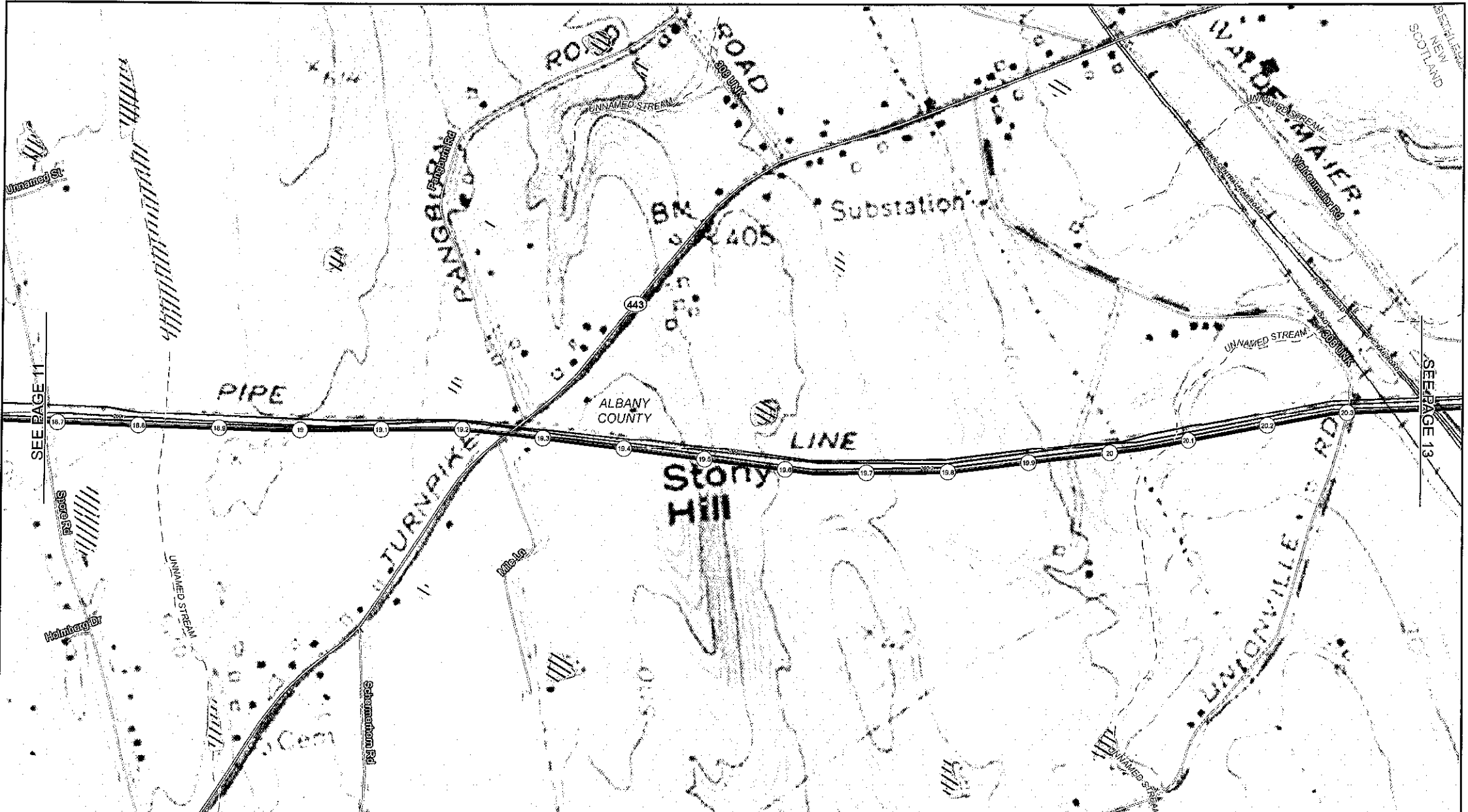

Legend

- | | | |
|---|----------------------------------|---------------------------------------|
| ① MILE POST | CONSTITUTION PIPELINE CENTERLINE | POTENTIAL COMPRESSOR STATION LOCATION |
| ⊙ METER LOCATIONS | SWN PIPELINE | NW WETLAND |
| ⊙ WELLS | EXISTING TOP PIPELINE | NHD WATERSBODY |
| — PROPOSED NORTHEAST ENERGY DIRECT MARKET PATH CENTERLINE | INTERSTATE | MUNICIPAL BOUNDARY |
| — PROPOSED NORTHEAST ENERGY DIRECT LATERAL CENTERLINE | MAJOR HIGHWAY | COUNTY BOUNDARY |
| | LOCAL ROAD | STATE BOUNDARY |
| | RAILROAD | |
| | NHD STREAM / RIVER | |

MAPS COMPILED UTILIZING EXISTING PUBLICLY AVAILABLE GIS RESOURCES.

TENNESSEE GAS PIPELINE COMPANY, L.L.C.
NORTHEAST ENERGY DIRECT PROJECT

(MARKET PATH COMPONENT)

ALBANY COUNTY
 NEW YORK

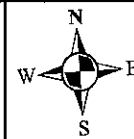

ABSOLUTE SCALE:
 1:7,200

REFERENCE SCALE:
 1 IN = 600 FEET



Hatch Mott MacDonald

150 Lower Westfield Rd.
 Holyoke, MA 01040
 Ph: (413) 535-0135 Fax: (413) 535-0136

PRELIMINARY FOR REVIEW 9/11/2014
 TENNESSEE GAS PIPELINE, LLC PROPRIETARY

DRAWN BY:	HMM 9/11/2014
CHECKED BY:	HMM
APPROVED BY:	HMM
REV. DATE:	9/11/2014
REVISION:	1
DESC:	SUBMIT FOR REVIEW
PAGE:	12 OF 99